

EQUIPMENT

GEOSTAR Series

Logging winch truck **GEOSTAR-11, GEOSTAR-12, GEOSTAR-13**

DESCRIPTION



1. Winch

Winch consists of the removable drum and the line packer with mechanical drive. The winch reducer has the built-in multidisk friction clutch providing the protection of a wire from breakage, the opportunity of smooth connection the torque to the drum during raising, the drum's braking during lowering, the simplification of winch control (no adhesion control duplicating). There is the rigid brake-stop and additional friction brake. System has the ability to lower the down-hole equipment using its own weight.

2. Truck chassis

Truck is designed on full-driving chassis: Russians (GAZ, ZIL, URAL, KamAZ) or others (Volvo, Mercedes).

3. Van body

It is available to produce the isothermal body in two variants: mono-cabin and two-cabin. These bodies are differed by availability of the inner partition with the door, and sets of built-in furniture as well.

WINCH MODELS

For GEOSTAR-11. Winch drive is **mechanical** from the transfer gear-box of truck engine, or from transmission gear-box through power-takeoff.

For GEOSTAR-12. Winch drive is **electric** from the external power supply 220V-380V or (and) from independent electro generator (petrol or diesel).

For GEOSTAR-13. Winch drive is **hydraulic** from transmission gear-box and further using the hydrostatic transmission.

An auxiliary drive is manual



MARKING

Chassis model	Truck marking according to the winch drive		
	Mechanical	Electric	Hydraulic
GAZ	GEOSTAR-11-20	GEOSTAR-12-20	GEOSTAR-13-20
ZIL	GEOSTAR-11-30	GEOSTAR-12-30	GEOSTAR-13-30
URAL	GEOSTAR-11-40	GEOSTAR-12-40	GEOSTAR-13-40
KamAZ	GEOSTAR-11-50	GEOSTAR-12-50	GEOSTAR-13-50
Volvo	GEOSTAR-11-60	GEOSTAR-12-60	GEOSTAR-13-60

STANDARD SUPPLY SET

- Truck chassis;
- mono-cabin isothermal van-body, aluminum siding;
- standard furniture set consists of folding table, wardrobe, bench-vice, hoisting control panel and operator sittings;
- winch LKI-1 with the drive, mechanical position counter, drive controls and two drums;
- doublers for monitoring devices of engine, for clutch, for power takeoff switcher;
- independent heater OV-65;
- searchlight for the wellhead lightning;
- loud-speaker;
- mechanical winch for removable drum maintenance;
- first-aid kit;
- fire extinguisher;
- breakdown triangle.

SUPPLY SET TO ORDER

- Two-cabin van-body;
- stand-alone AC generator;
- electronic position and velocity counter;
- wire line;
- stairs for drums replacing;
- van-body electrical equipment 220-380 V: cable to ground, cable for external power supply, electrical control unit, lighting;
- suite of equipment for long-term habitation;
- lubricator for wellhead up to 35 MPa;
- turning jib-crane for loading/unloading easing;
- containers for equipment transportation;
- heater from the engine cooling system.

**Logging winch truck GEOSTAR-11,
 GEOSTAR-12, GEOSTAR-13
 On the GAZ-3308 chassis**

**PLANNING
 Habitable van (SCHEME)**

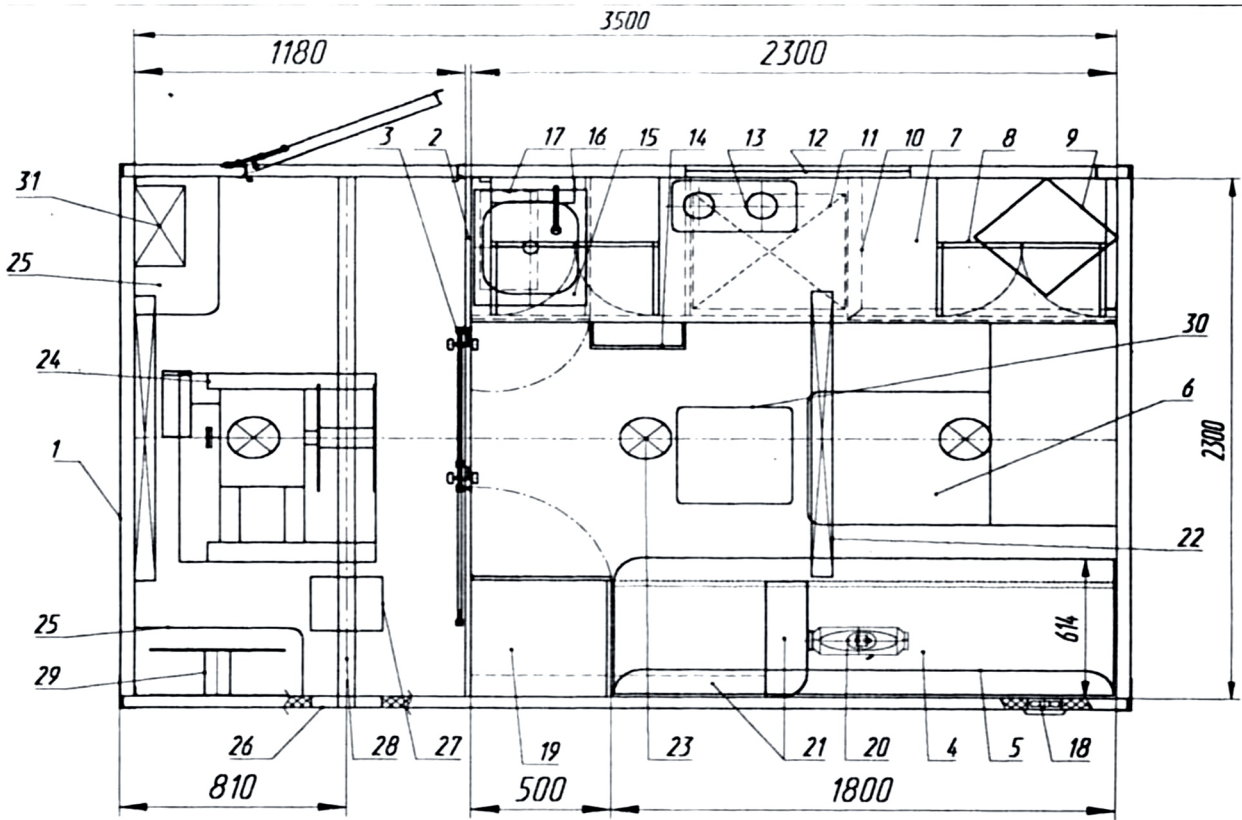

- | | | |
|-----------------------|---------------------------|-------------------------|
| 1 - Van | 12 - Window | 23 - Tell-tale light |
| 2 - Partition | 13 - Electric furnace | 24 - Winch |
| 3 - Slide-off door | 14 - Drawers | 25 - Bench |
| 4 - Berth with box | 15 - Sink | 26 - Hatch |
| 5 - Folding berth | 16 - Waterheater | 27 - Manual winch |
| 6 - Drop table | 17 - Fuel can, 25 liters | 28 - Manual winch guide |
| 7 - Cook table | 18 - Fan | 29 - Movable winch drum |
| 8 - Cupboard | 19 - Wardrobe | 30 - Seat |
| 9 - TV set | 20 - Heater | 31 - Control panel |
| 10 - Generator module | 21 - Air pipe | |
| 11 - Refrigerator | 22 - Fluorescent lighting | |

SHOTS

